

ASSEMBLY INSTRUCTIONS MANUAL

65504 65544 65564 - METAL FRAMED WELL-TOP
REGISTER STAND

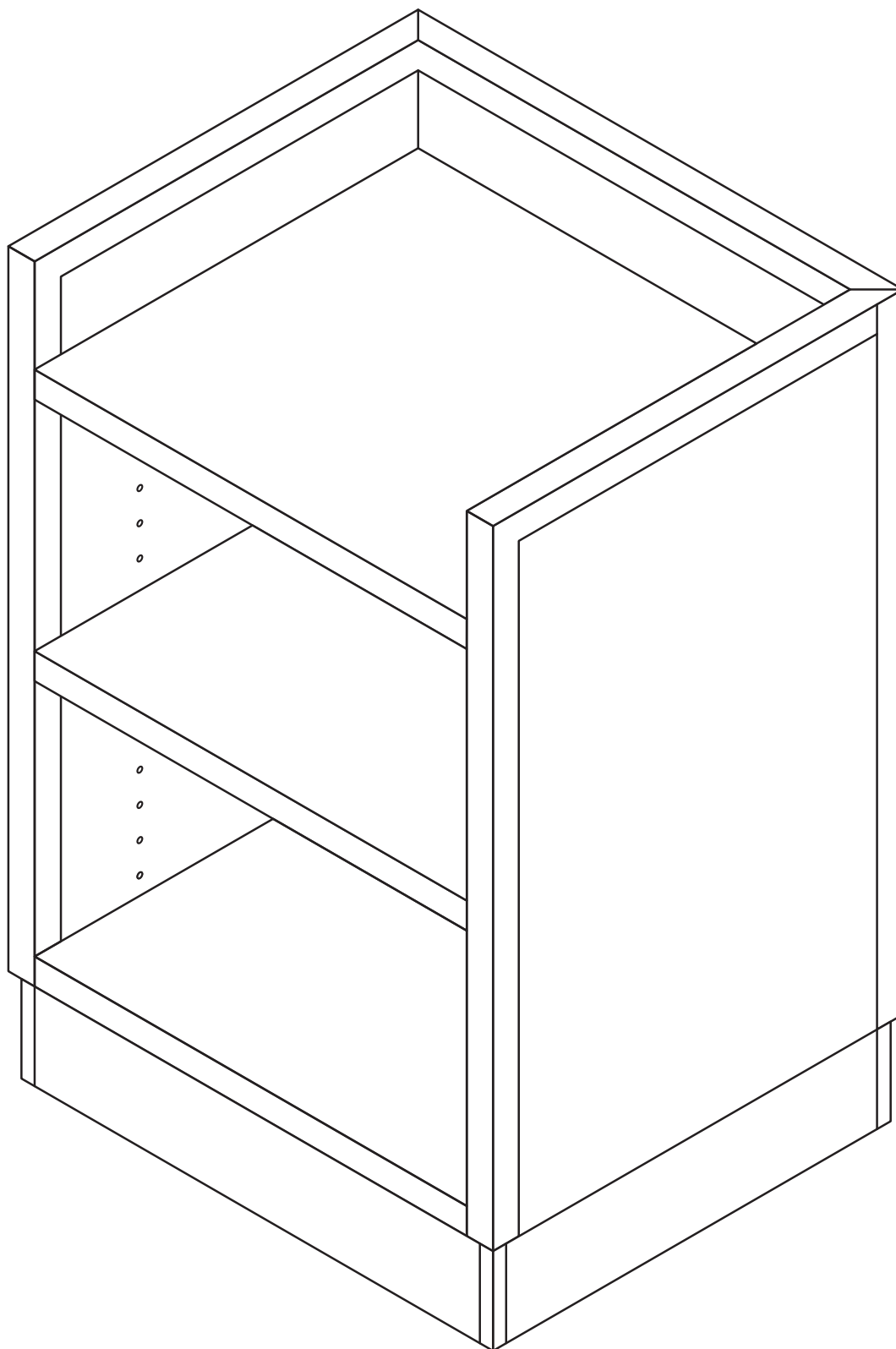

ASSEMBLY INSTRUCTIONS MANUAL

65504 65544 65564 - METAL FRAMED WELL-TOP REGISTER STAND

PARTS IN CARTON:



CAM LOCK PINS
(XX EACH)

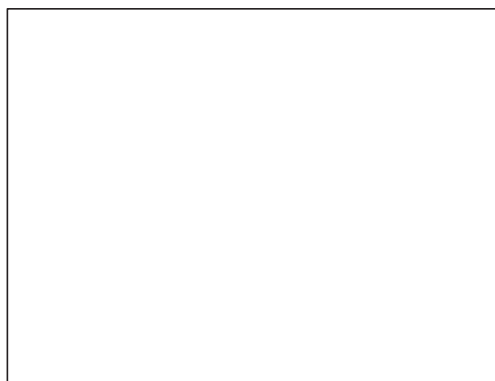

SHELF
(1 EACH)

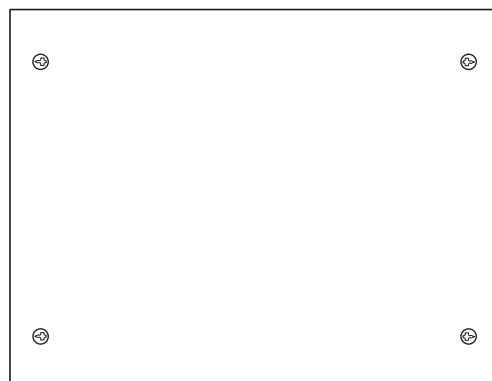

REGISTER SURFACE
(1 EACH)



CORNER CAP
(4 EACH)



CORNER CAP
(4 EACH)



KICK PLATE PANEL
(4 EACH)

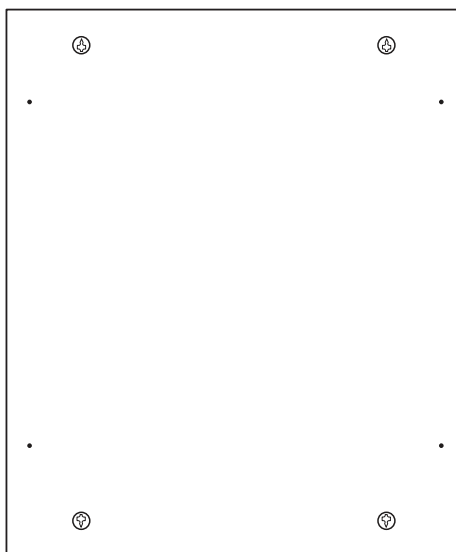

BASE PANEL
(4 EACH)

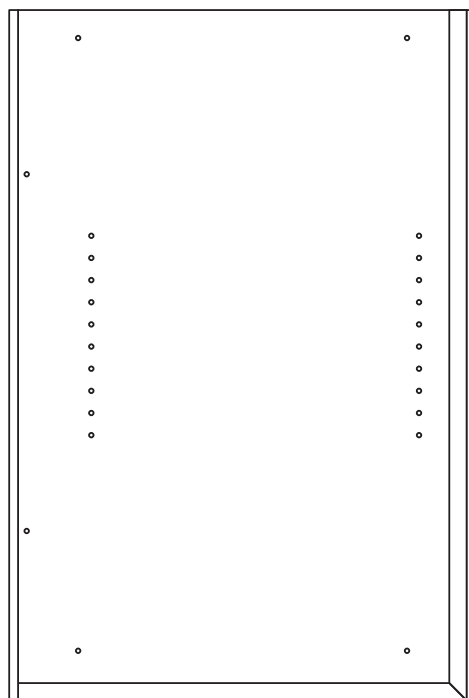

FRONT PANEL
(1 EACH)

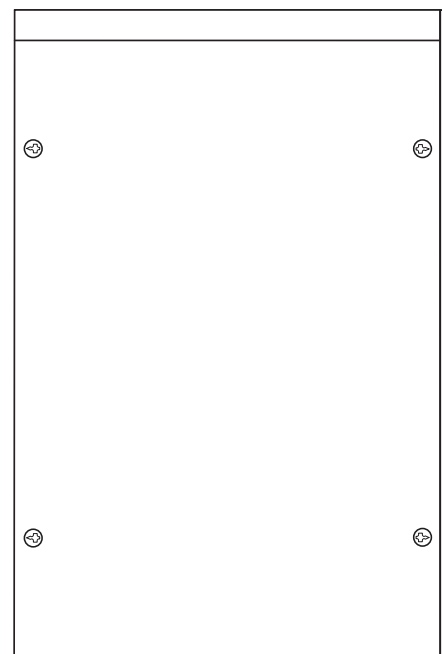

SIDE PANEL
(2 EACH)

ASSEMBLY INSTRUCTIONS MANUAL

65504 65544 65564 - METAL FRAMED WELL-TOP REGISTER STAND

STEP 1

INSERT CAM LOCK PINS INTO EACH PANEL. (USING A MANUAL SCREW DRIVER IS BEST, TO HELP AVOID OVER TIGHTENING.)

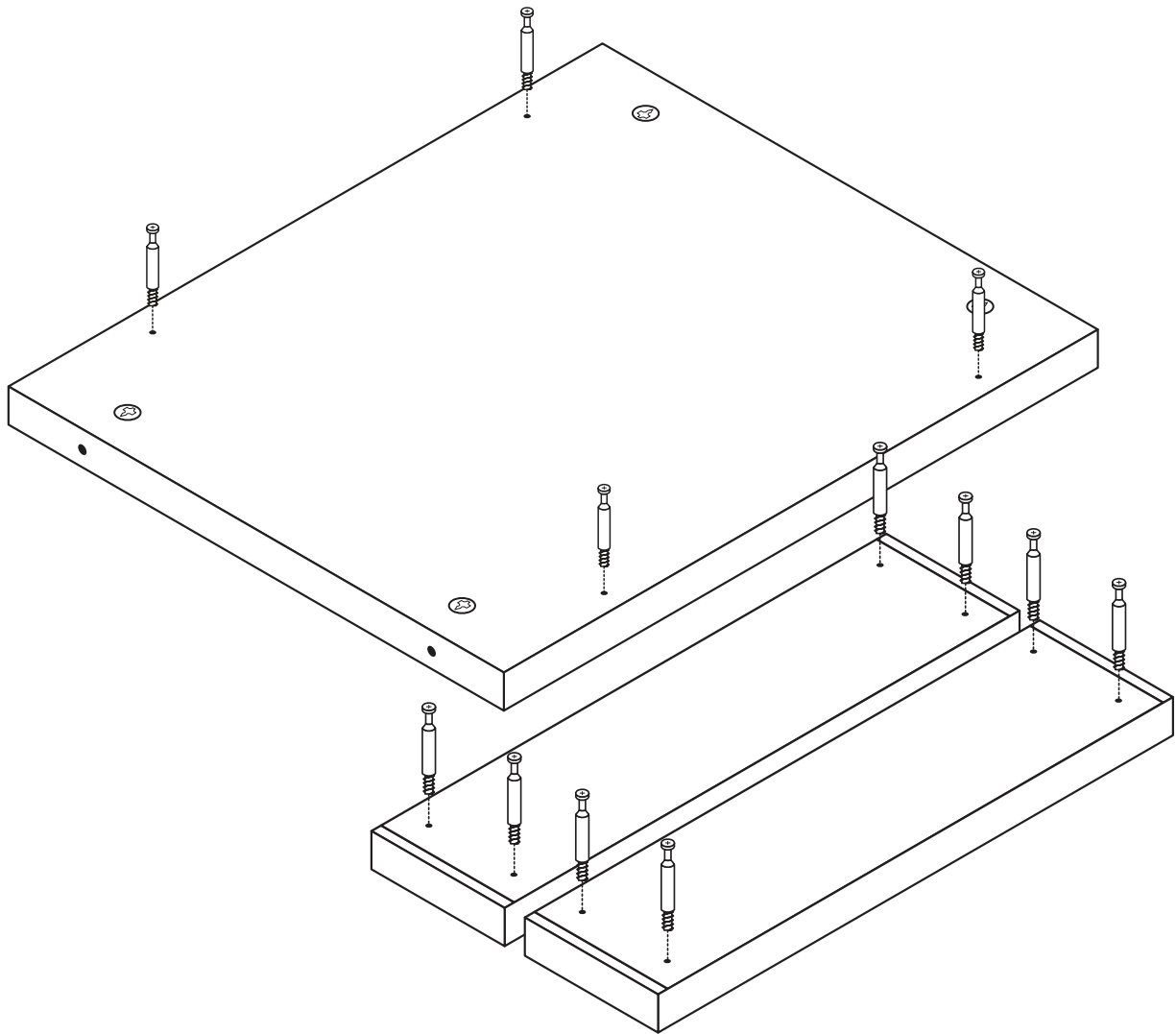

STEP 2

ENSURE EACH PRE-INSERTED CAM IS ORIENTED SO THE CAM ARROW IS FACING THE CORRESPONDING HOLE.

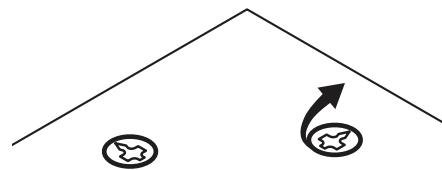

ASSEMBLY INSTRUCTIONS MANUAL

65504 65544 65564 - METAL FRAMED WELL-TOP REGISTER STAND

STEP 3

ALIGN SIDE PANEL CAM LOCK PINS
WITH CORRESPONDING HOLES, THEN
TIGHT CAMS. NEXT CAREFULLY
LOWER THE SIDE ASSEMBLY
ONTO THE BASE PANEL.
(TIGHTEN CAMS)

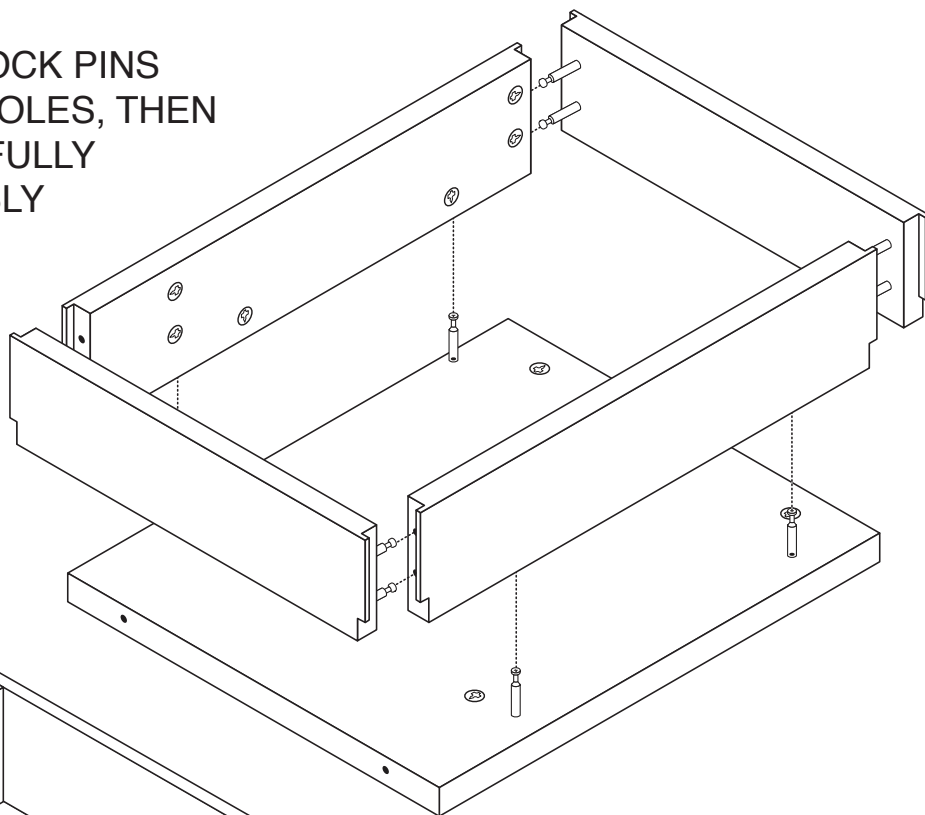

STEP 4

USING A RUBBER Mallet,
INSERT EACH CORNER
CAP ONTO THE KICK
PLATE CORNERS.

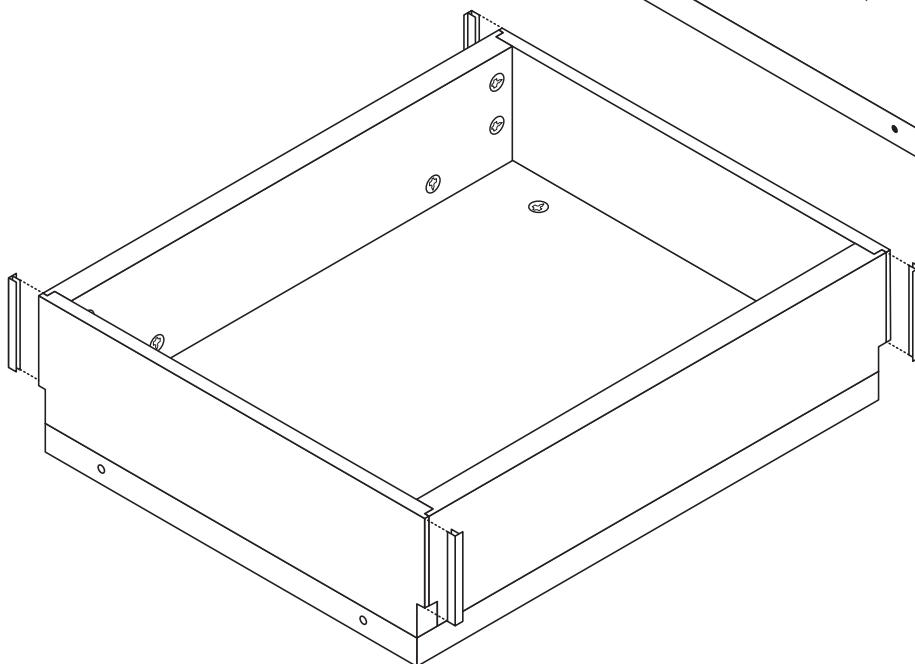

STEP 5

INSERT CAM LOCK PINS INTO EACH
PANEL. (USING A MANUAL SCREW
DRIVER IS BEST, TO HELP AVOID
OVER TIGHTENING.)

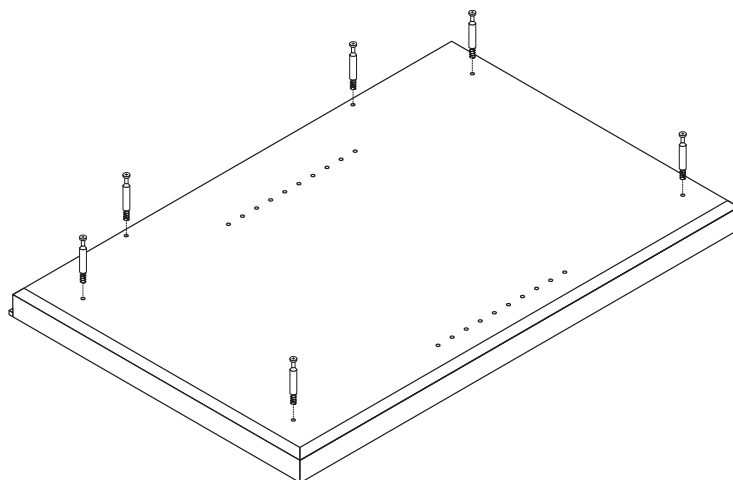

ASSEMBLY INSTRUCTIONS MANUAL

65504 65544 65564 - METAL FRAMED WELL-TOP REGISTER STAND

STEP 6

CAREFULLY LOWER THE BOTTOM DECK ASSEMBLY ONTO THE SIDE PANEL.
(TIGHTEN CAMS) THEN LOWER THE REGISTER SURFACE PANEL ONTO THE
SIDE PANEL. (TIGHTEN CAMS)

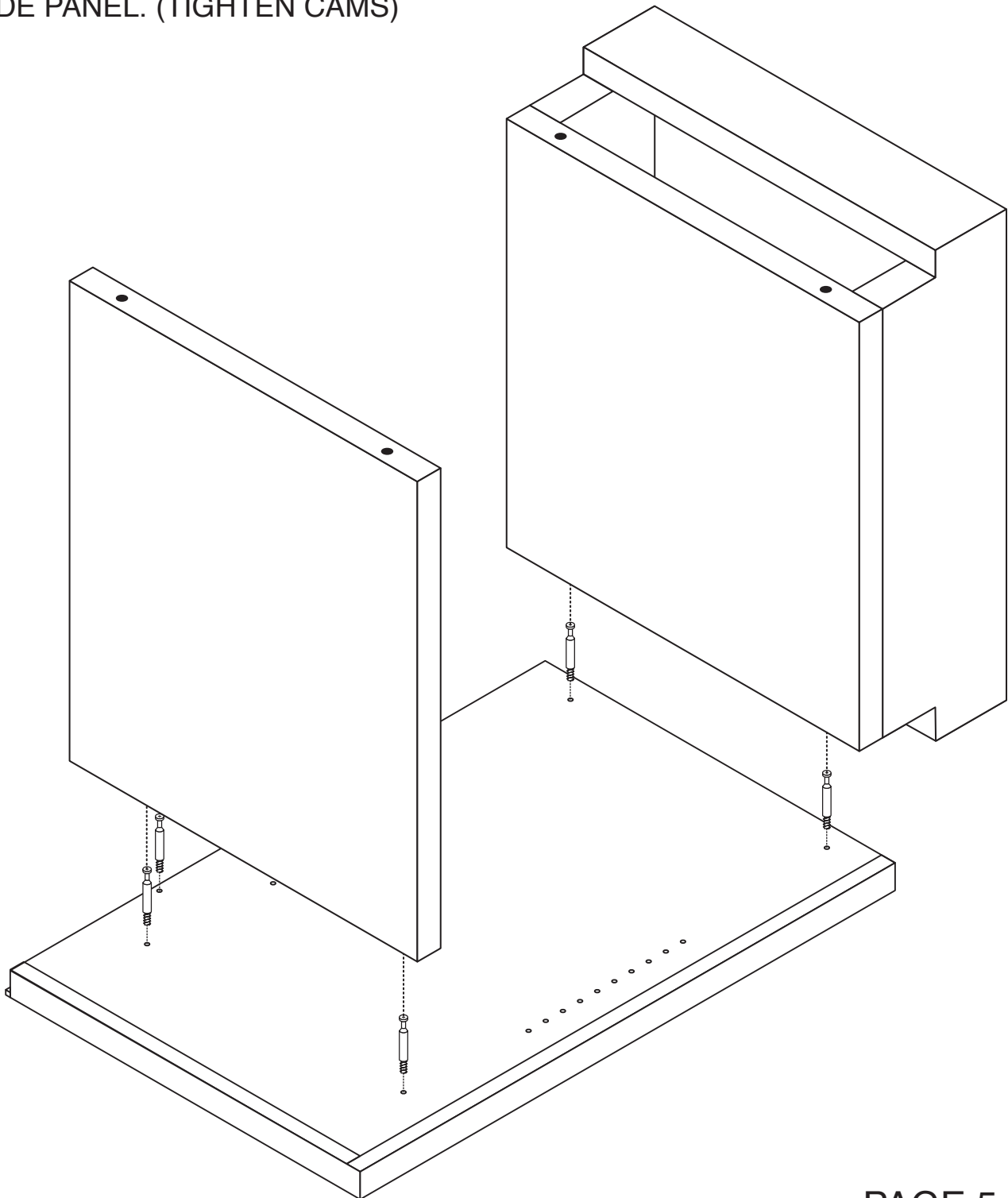

ASSEMBLY INSTRUCTIONS MANUAL

65504 65544 65564 - METAL FRAMED WELL-TOP REGISTER STAND

STEP 7

LOWER THE FRONT PANEL ONTO THE SIDE
PANEL. (TIGHTEN CAMS)

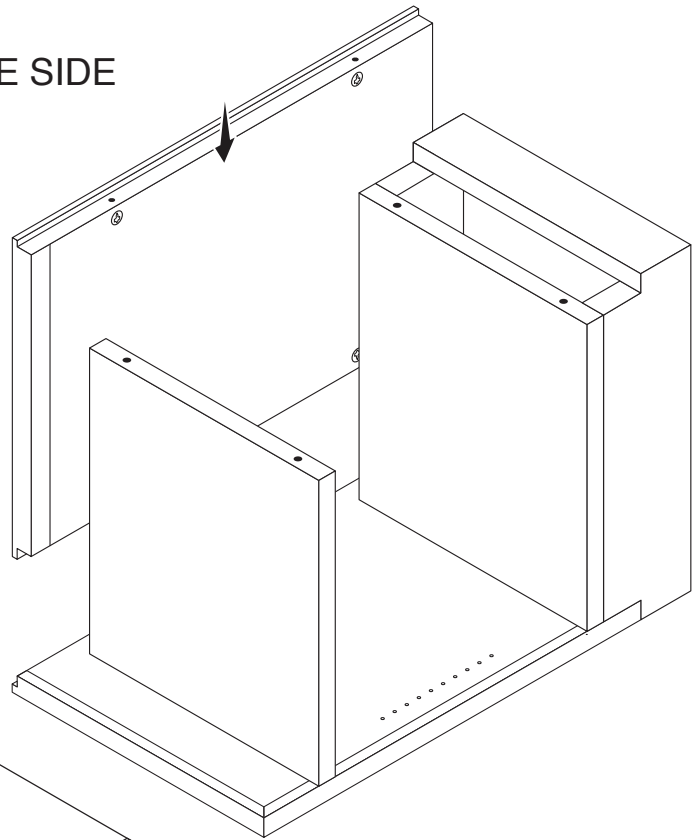

STEP 8

LOWER THE SIDE
PANEL ONTO THE FINAL
ASSEMBLY. (TIGHTEN
CAMS)

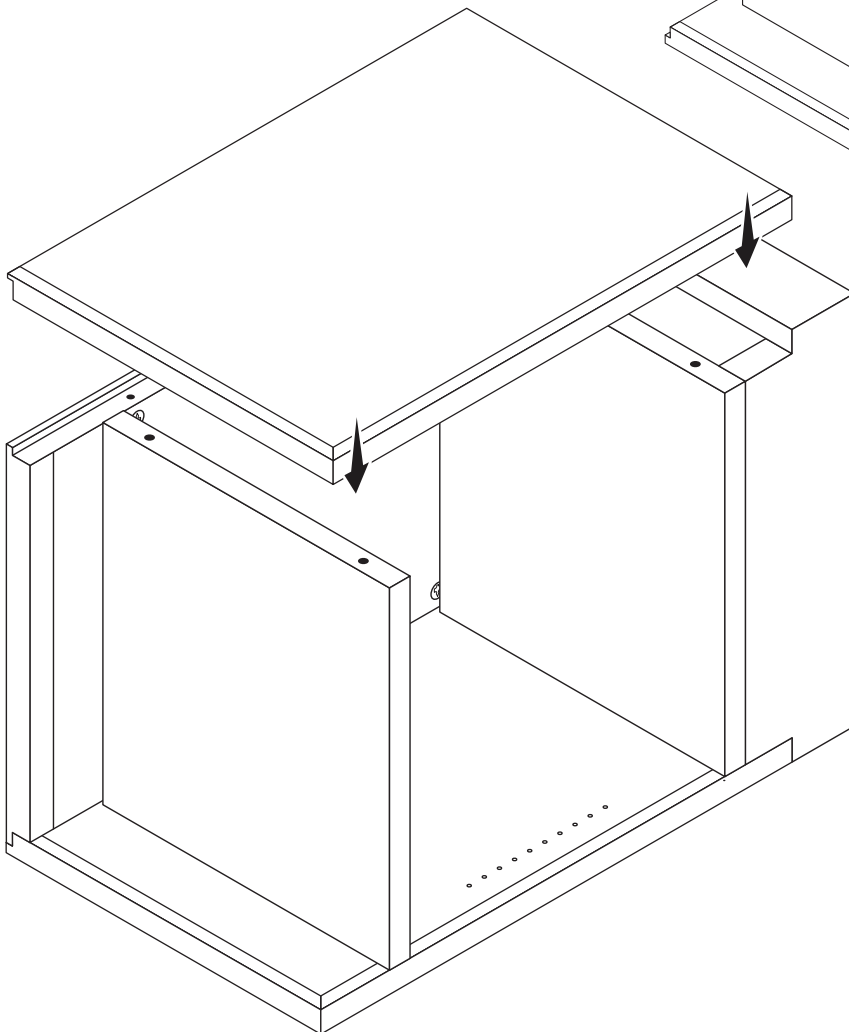

ASSEMBLY INSTRUCTIONS MANUAL

65504 65544 65564 - METAL FRAMED WELL-TOP REGISTER STAND

STEP 9

USING A RUBBER Mallet, INSERT EACH CORNER CAP ONTO THE KICK PLATE CORNERS.

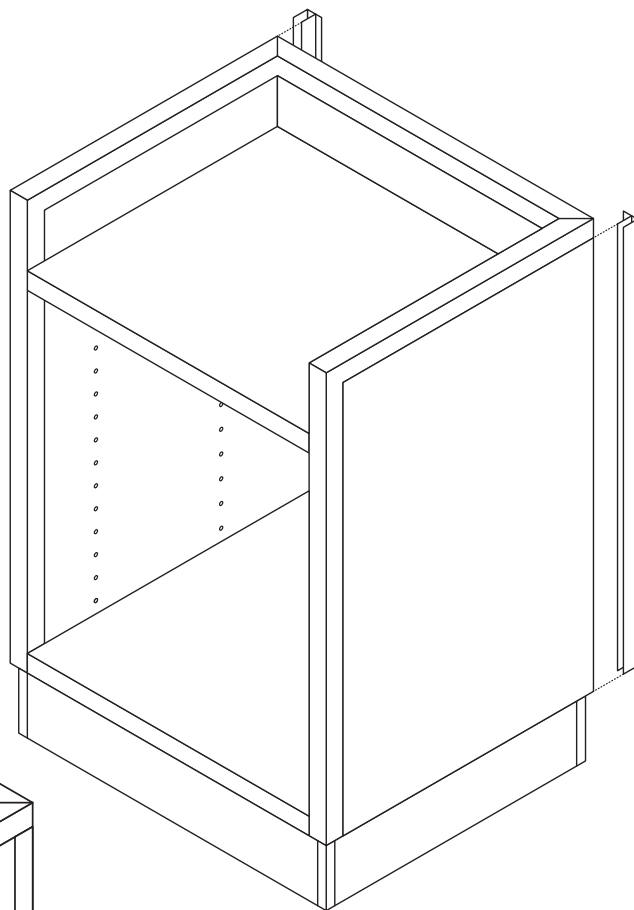

STEP 10

PLACE SHELF PINS AT DESIRED LOCATIONS. SLIDE IN THE SHELF PANEL & SET ONTO SHELF PINS.

